

Instruction Sheet

WEST PENN
WIRE Since 1971
AV, SECURITY & NETWORKING SOLUTIONS

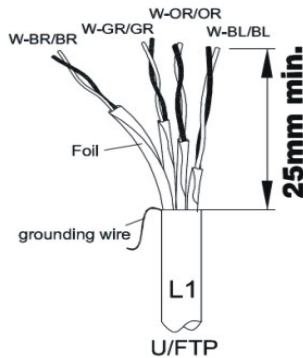
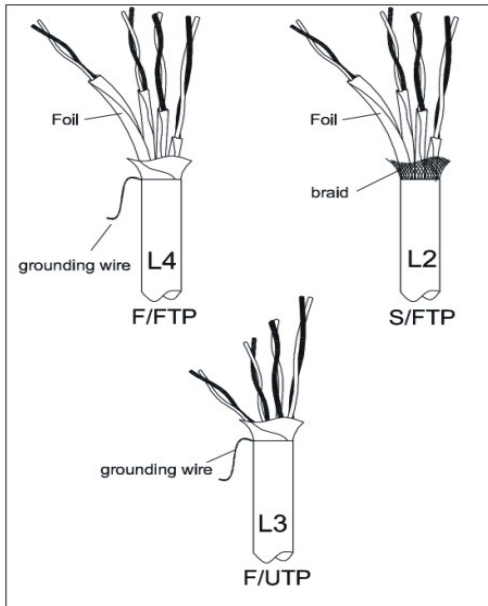

Step 1:

Strip the cable for minimum 25 mm, pull the foil or braided shield back over the jacket.

NOTES:

IDC is suitable for 22~24 AWG wires.

Step 2:

Insert the wires into the cap through the holes.

Step 3:

Lay the wires to their correct positions based on the color code. (T568A/T568B)

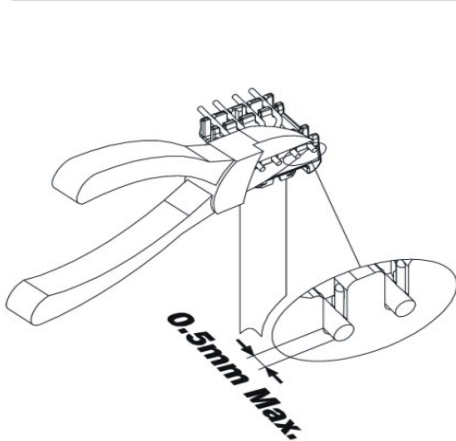

Step 4:

Cut the excess wires off. The tips of the wires should protrude no more than 0.5mm.

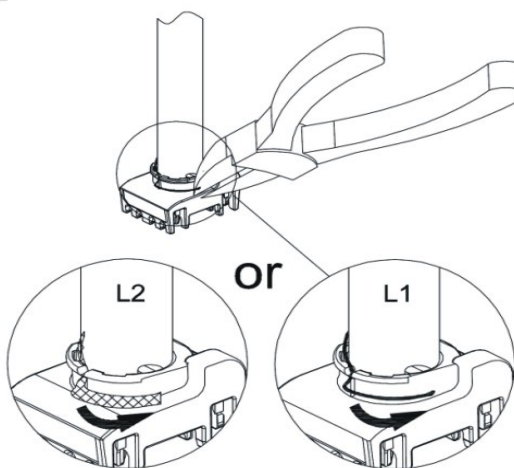

Step 5:

Wrap the grounding wire, braid around the cap as shown picture (Leave at least 7mm for grounding)

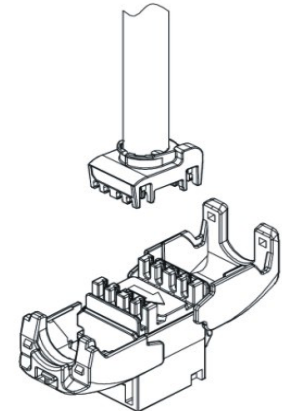

Step 6:

Put the cap on the IDC tower. The arrows on the jack and the cap should face the same direction. Put the cap into position.

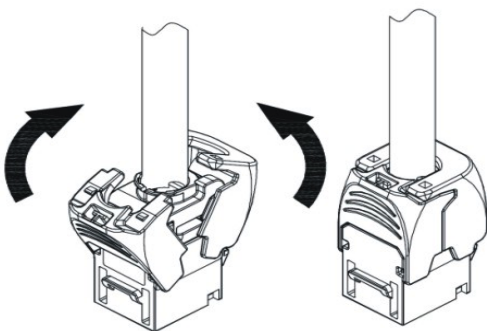

Step 7:

Close the jaws until hearing the click.

Disassembly Instruction:

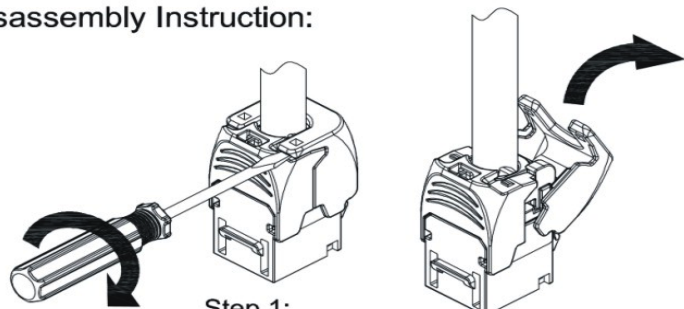

Step 1:

Insert the slotted screwdriver into the slot and rotate to open the jaws.